

# DISMANTLING JOINTS

## DISMANTLING JOINT NP25 FLANGES DIN PN-25.



BeValve

TECFLW

TF-DJ-DI-F25



### APPLICATION:

Are used next to valves, in installations where occasional dismantling is necessary, without substituting any pipe.

### GENERAL CHARACTERISTICS:

Range from ND80 up to ND2000.  
Low head loss.  
Tightness joint in the toric section.  
Epoxy paint 250 microns RAL 5017.

### STANDARDS:

Mounting with flanges: ISO 253 PN25.  
Pressure Test: EN 12266-1.  
Body: 37,5 bar.

### WORKING CONDITIONS:

Maximum Working Pressure: 25 bar.  
Working Temperature: - 5 °C / +80 °C.

### DIMENSIONS: PN25

DN	D2	D4	D5	L1	L2	d	N	t	Weight
80	98	160	200	210	330	19	8	7	20
100	118	190	235	220	340	23	8	7,2	25
125	144	220	270	220	370	28	8	7,5	31
150	170	250	300	230	370	28	8	7,8	42
200	222	310	360	230	370	28	12	8,4	62
250	274	370	425	250	410	31	12	9	91
300	326	430	485	250	410	31	16	9,6	112
350	378	490	555	270	440	34	16	10,2	155
400	429	550	620	280	480	37	16	10,8	197
450	480	600	670	280	480	37	20	11,4	228
500	532	660	730	300	480	37	20	12	292
600	635	770	845	320	520	40	20	13,2	398
700	738	875	960	340	530	43	24	14,4	442
800	842	990	1085	360	600	49	24	15,6	576
900	945	1090	1185	380	600	56	28	16,8	658
1000	1048	1210	1320	400	650	56	28	18	863
1200	1255	1420	1530	450	720	56	32	20,4	1332
1400	1462	1640	1755	480	770	62	36	22,8	1620
1600	1668	1860	1975	510	815	62	40	25,2	2186
1800	1875	2070	2195	540	865	70	44	27,6	3066
2000	2082	2300	2425	580	930	70	48	30	3174

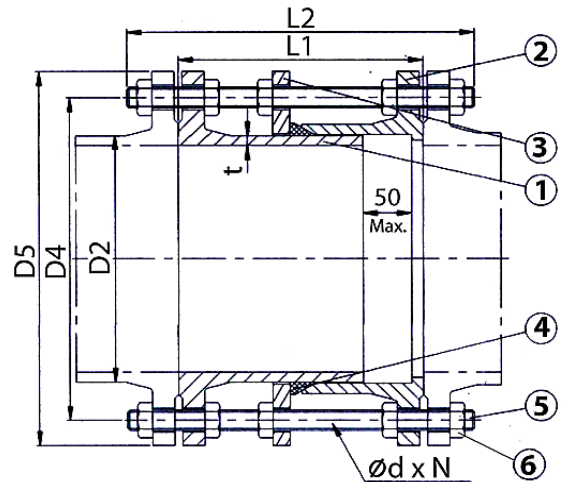

### CONSTRUCTION:

No.	Part	Material	Options
1	Body	Ductile Iron GJS500	Steel
2	Flanges	Ductile Iron GJS500	Steel
3	Retaining Flange	Ductile Iron GJS500	NBR
4	Sealing Ring	EPDM	NBR
5-6	Rods & Nuts	Zinc plated Steel	S.Steel 304

The specifications of the presented products are open to modifications without previous advice.

Bevalve Shanghai

Room 504-40, 5/F, West Office Tower, Shanghai Centre, No. 1376 West Nanjing Road

Jing an District - Shanghai, 200040, P.R.China

Tel +86 (21) 60103107 Email info@bevalve.com

[www.bevalve.com](http://www.bevalve.com)